

Guide for AG-CX350 Ver.3.0 clip import - from SD,P2 card on - (Mac) Final Cut Pro X Ver.10.4

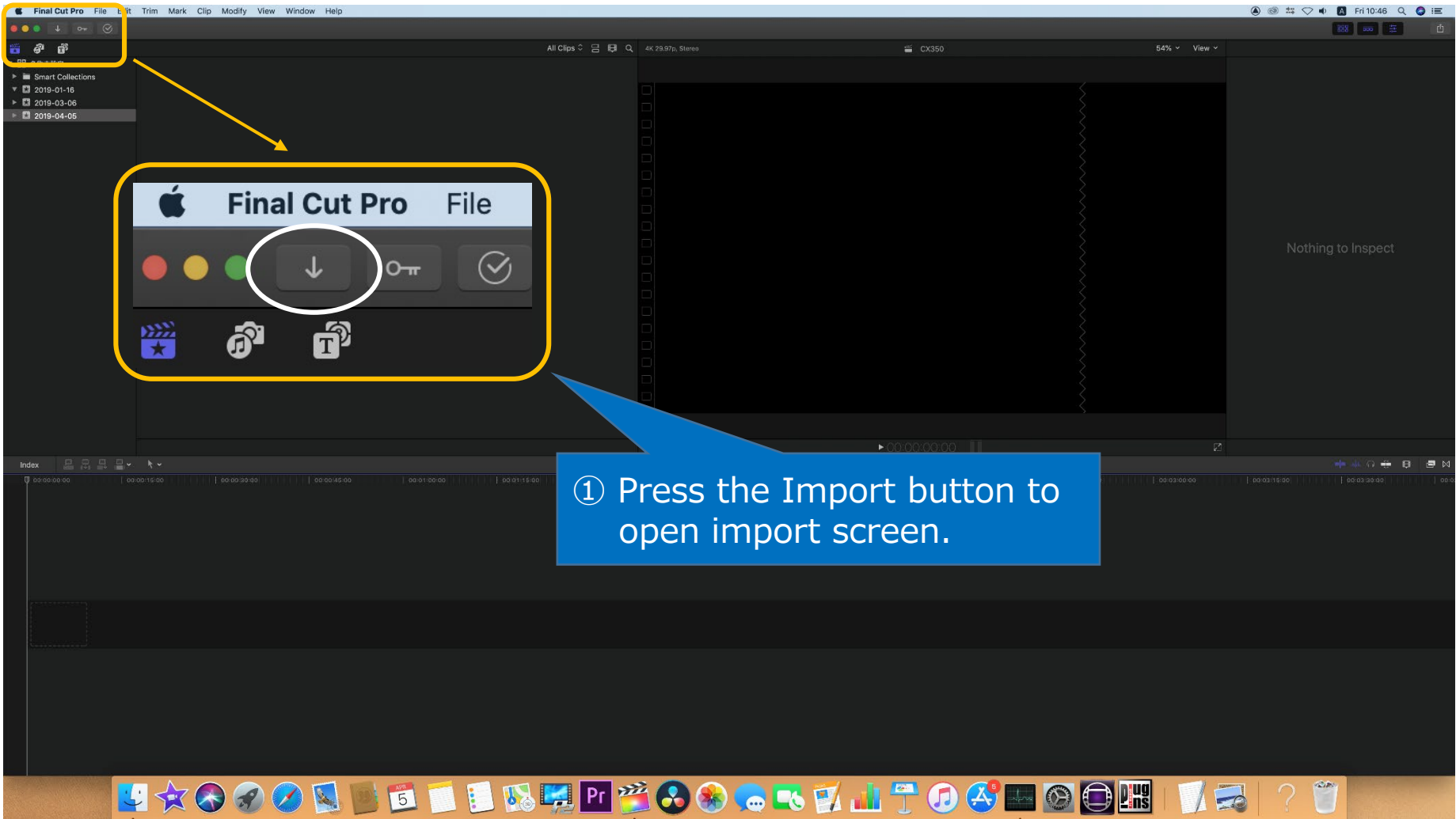

① Press the Import button to open import screen.

Guide for AG-CX350 Ver.3.0 clip import - from SD,P2 card on - (Mac) Final Cut Pro X Ver.10.4

The screenshot shows the 'Media Import' window in Final Cut Pro X. The 'CAMERAS' list on the left has 'A004' selected. The 'DEVICES' list shows 'Macintosh HD'. The 'FAVORITES' list includes 'alliance' and 'Desktop'. The 'Clips' table is visible, with two rows of clip data. The 'Import All' button is highlighted in yellow. The 'Close window after starting import' checkbox is checked and highlighted in yellow. The 'Import All' button is also highlighted in yellow.

② Select SD or P2 card.

③ Select any clips displayed in the screen to import.

④ Click Import All button.

Clip #1	Resolution	Frame Rate	Start Time	End Time	Duration	Date
A004C001J90404_B90C	1920 x 1080	59.94	02:00:00,00	02:00:08,00	00:00:08,00	Apr 4, 2019 9:52:07
A004C001J90404_B90C	3840 x 2160	29.97	01:00:00,00	01:00:10,15	00:00:10,15	Apr 4, 2019 9:50:28

Close window after starting import

Stop Import Import All

Guide for AG-CX350 Ver.3.0 clip import - from SD,P2 card on - (Mac) Final Cut Pro X Ver.10.4

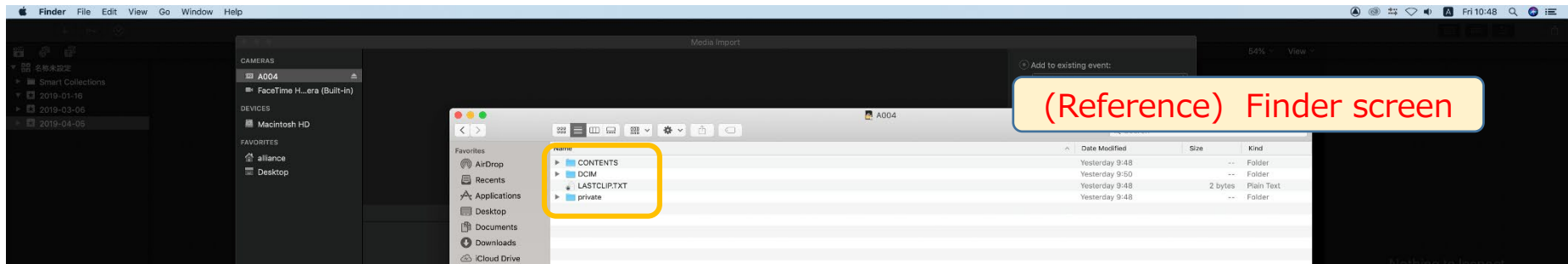

<Workaround when FCPX does not recognize the MOV or AVCHD file>

AVCHD or MOV files might not be recognized due to P2 CONTENTS folder.

- ① In case of import from SD card:
Mount SD card first, then restart Final Cut Pro X.
- ② In case of HDD :
 1. Restart Final Cut Pro X.
 2. If it's still not recognized after restarting Final Cut Pro X,
please separate CONTENTS folder from others.