

# Remote Camera System – Specifications & Dimensions

As of April, 2018

## AW-UE70W/K AW-UN70W/K

General	
Power Requirements	DC 12 V (Supplied AC adaptor) DC 42 V to 57 V (PoE+ power supply)
Current consumption	1.3 A (Supplied AC adaptor) 0.5 A (PoE+ power supply)
Ambient Operating Temperature	0 °C to 40 °C (32 °F to 104 °F)
Storage Temperature	-20 °C to 50 °C (-4 °F to 122 °F)
Allowable Humidity Ranges	20 % to 90 % (no condensation)
Mass	Approx. 1.5 kg (3.30 lb)
Dimensions (W x H x D)	160 mm x 186 mm x 179 mm (6-5/16 inches x 7-41/128 inches x 7-3/64 inches) [excluding protrusions, direct ceiling mount bracket]
Finish	[AW-UE70W/AW-UN70W] Pearl white [AW-UE70K/AW-UN70K ] Metallic black
Controller Supported*	AW-RP50, AW-RP120G, AK-HRP200G
Camera Unit	
Imaging Sensors	1/2.3-type MOS
Lens	Optical 20x zoom, F1.8 to F3.6 [f=4.08 mm (5/32 inches) to 81.6 mm (3-7/32 inches); 35 mm (1-3/8 inches) equivalent: 29.5 mm (1-5/32 inches) to 612.0 mm (24-3/32 inches)]
Focus	Switching between auto and manual
Focus distance	Entire zooming range: 1.5 m (4.92 ft) Wide end: 10 cm (0.33 ft)
Color separation optical system	On-chip color filter system
Minimum Illumination	59.94 Hz 0.7 lx (50 IRE, F1.8, 48 dB, 1/60 without accumulation) 0.35 lx (50 IRE, F1.8, 48 dB, 1/30 with accumulation [Frame Mix 6 dB])
	50 Hz 0.7 lx (50 IRE, F1.8, 48 dB, 1/50 without accumulation) 0.35 lx (50 IRE, F1.8, 48 dB, 1/25 with accumulation [Frame Mix 6 dB])
Horizontal Resolution	4K: 1300 TV lines Typ (Center area) HD: 1000 TV lines Typ (Center area)
Gain Selection**	Auto, 0 dB to 48 dB (3 dB step)
Frame Mix**	Auto, Off, 6 dB, 12 dB, 18 dB, 24 dB
ND filter	Auto*, Through, 1/4, 1/16, 1/64
Electronic Shutter Speed	During Full Auto 1/60 to 1/2000 (Auto Slow Shutter: Off)[59.94 Hz] 1/30 to 1/2000 (Auto Slow Shutter: On)[59.94 Hz] 1/50 to 1/2000 (Auto Slow Shutter: Off)[50 Hz] 1/25 to 1/2000 (Auto Slow Shutter: On)[50 Hz]
	During Auto 1/60 to 1/2000 [59.94 Hz] 1/50 to 1/2000 [50 Hz]
Synchro Scan	59.94 Hz 1/100, 1/250, 1/500, 1/1000, 1/2000, 1/4000, 1/10000 [59.94 Hz] 1/120, 1/250, 1/500, 1/1000, 1/2000, 1/4000, 1/10000 [50 Hz]
	50 Hz 59.94 Hz to 660.09 Hz (255 step) 50.00 Hz to 570.12 Hz (255 step)
Gamma	Off, Normal (Low, Mid, High), Cinema
White Balance	ATW, AWB A, AWB B, ATW, 3200K, 5600K, VAR (2400K to 9900K)
Chroma Amount Variability	±3 step
Scene File	Full Auto, Manual1, Manual2, Manual3
Synchronization System	
Synchronization System	Internal synchronization/External synchronization (BBS, Tri-level sync)
Image Stabilization	
Image Stabilization	Optical (FHD, 4K)/4-axis hybrid image stabilizer (FHD) for stable

Input	
Power	DC 12 V IN, PoE+ (IEEE802.3at standard)
MIC/LINE Input	Stereo mini-jack (ø3.5 mm) Input impedance: Approx. 2 kΩ (unbalanced) [Mic input] •Supported microphones: Stereo mic (plug-in power, on/off switching via menu) •Supplied voltage: 2.5 V ± 0.5 V •Mic input level: -60 dBV ± 3 dBV (0 dB=1 V/Pa, 1 kHz) [Line input] •Input level: -10 dBV ± 3 dBV
G/L IN	BBS (Black Burst Sync) signal and tri-level sync supported (BNC x 1)
Output	
Video Output	HDMI HDMI connector • HDCP is not supported. • VIERA Link is not supported.
	3G/HD-SDI OUT Compliant with the SMPTE424/SMPT292M standards/75 Ω (BNC x 1)
Input/Output	
Input/Output Connector	LAN LAN connector for IP control (RJ-45) Equipped with straight/crossover cable auto detection function
	RS-232C Mini DIN 8-pin (IN) Mini DIN 8-pin (OUT)
	RS-422 CONTROL IN RS422A (RJ-45)
	USB Mini-B port
	SD Card microSD card slot
USB connection	* This may vary depending on the operating environment.
Video output	USB Video Class Ver1.0
Video compression format	Motion JPEG
Resolution	3840 x 2160, 1920 x 1080, 1280 x 720, 640 x 360
Frame rate	max 30 fps (59.94 Hz) max 25 fps (50 Hz)
Audio output	USB Audio Class Ver1.0
Audio compression format	Linear PCM, 48 kHz, 16-bit, 2 channels
Transfer modes(JPEG)	3840 x 2160 59.94 Hz: 5fps, 50 Hz: 5fps
	1920 x 1080/1280 x 720/640 x 360 59.94 Hz: 30fps/15fps/5fps, 50 Hz: 25fps/12.5fps/5fps
Supported models	Devices standardly equipped with a USB 2.0 compatible port
Pan-tilt Head Unit	
Installation Method	Stand-alone (Desktop) or suspended (Hanging)**
Pan/tilt Operation Speed	Maximum speed during preset: 300°/s Maximum speed during manual: 90°/s
Panning Range	±175°
Tilting Range**	-30° to 90°**
Quietness	During preset: NC40 or less During manual: NC35 or less
Camera/pan-tilt head control	
IP connecting cable	• When connecting through a PoE+ hub: LAN cable** (category 5e or above), max. 100 m (328 ft) • When a PoE+ hub is not used: LAN cable** (category 5 or above) max. 100 m (328 ft)
AW protocol connecting cable	LAN cable** (category 5 or above, straight cable), max. 1000 m (3280 ft)
Standard protocol connecting cable	Mini DIN 8-pin cable, male

SD card recording	
SD card recording	MPEG-4 AVC file standard compliant (.MP4)
Video compression format	MPEG-4 AVC/H.264 High Profile
Audio compression format	AAC-LC (48 kHz, 16 bit, 2 ch, 128 kbps)
Recording format /Bit rate	59.94 Hz 3840 x 2160/29.97p (Up to 72 Mbps), 1920 x 1080/59.94p (Up to 28 Mbps), 1920 x 1080/29.97p (Average 15 Mbps/ Average 10 Mbps/Average 6 Mbps), 1280 x 720/59.94p (Average 15 Mbps), 1280 x 720/29.97p (Average 8 Mbps/ Average 4 Mbps/Average 2 Mbps/Average 1 Mbps)
	50 Hz 3840 x 2160/25p(Up to 72 Mbps), 1920 x 1080/50p(Up to 28 Mbps), 1920 x 1080/25p(Average 15 Mbps/ Average 10 Mbps/Average 6 Mbps), 1280 x 720/50p(Average 15 Mbps), 1280 x 720/25p(Average 8 Mbps/ Average 4 Mbps/Average 2 Mbps/Average 1 Mbps)
Network	
Transfer modes	JPEG 1920 x 1080, 1280 x 720, 640 x 360, 320 x 180, 59.94 Hz (30fps/15fps/5fps)*, 50 Hz (25fps/12.5fps/5fps)*
	H.264 3840 x 2160, 1920 x 1080, 1280 x 720, 640 x 360, 320 x 180, 59.94 Hz (60fps*/30fps/15fps/5fps)*, 50 Hz (50fps*/25fps/12.5fps/5fps)*

Supported protocol	
IPv4	TCP/IP, UDP/IP, HTTP, HTTPS, RTSP, RTP, RTP/RTCP, FTP, DHCP, DNS, NTP, IGMP, UPnP, ICMP, ARP, RTSPoverTCP, RTSPoverHTTP, SSL(TLS), MultiCast/UniCast
	TCP/IP, UDP/IP, HTTP, HTTPS, RTSP, RTP, RTP/RTCP, FTP, DHCPv6, DNS, NTP, ICMPv6(MLD), RTSPoverTCP, RTSPoverHTTP, SSL(TLS), MultiCast/UniCast
IPv6	TCP/IP, UDP/IP, HTTP, HTTPS, RTSP, RTP, RTP/RTCP, FTP, DHCPv6, DNS, NTP, ICMPv6(MLD), RTSPoverTCP, RTSPoverHTTP, SSL(TLS), MultiCast/UniCast
i-OS, Android support	JPEG image display

### Standard Accessories

Mount bracket for installation surface (Hanging\*\*/ Desktop): 1, Drop-prevention wire (already attached to the unit): 1, Bracket mounting screws (bind-head) M4 x 10 mm: 4, Main unit mounting screw (with flat washer, spring washer) M3 x 6 mm: 1, Power cable (1.5 m [4.92 ft]): 1, AC adaptor: 1, CD-ROM: 1

\* 1: It may be necessary to upgrade the version of the controller so that the controller will support the unit. \* 2: During Auto, 6 dB to 48 dB (6 dB step) are available for AGC Max Gain setting. \* 3: During Auto, 0 dB, 6 dB, 12 dB and 18 dB are available for Auto F.Mix Max Gain setting. \* 4: "Auto" is available when "Scene" setting is "Full Auto". \* 5: To ensure safety, the unit must be secured using the mount bracket supplied. \* 6: Depending on the pan or tilt position, the camera may be reflected in the image. \* 7: Use of an STP (shielded twisted pair) cable is recommended. \* 8: The frame rate may be lower than the setting depending on the operating conditions. \* 9: When the image resolution is "3840x2160", "640x360" or "320x180", 60fps or 50fps cannot be selected for the frame rate. \* 10: To ensure more safety, AW-UE70W/K can be secured by using the direct ceiling mount bracket (WV-Q105A).

## Dimensions

Unit: mm(inches)

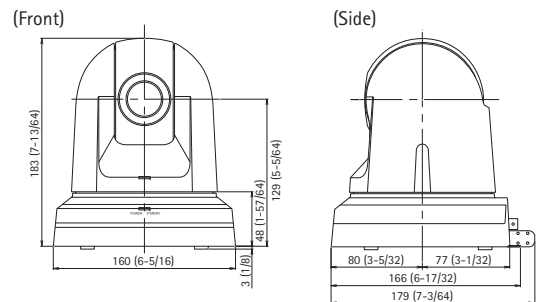

## Rear View



## Bottom View

Unit: mm(inches)

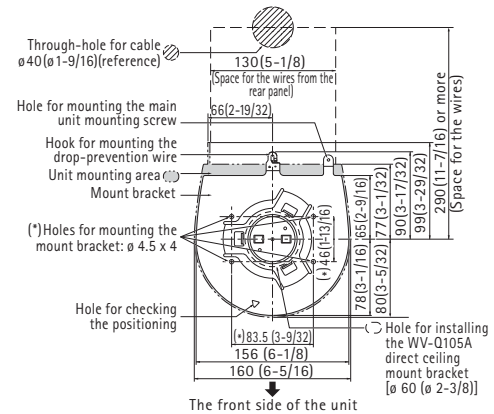

## Ceiling Installation View

